

DATED this 2nd day of June 1990

LONDON BOROUGH OF LEWISHAM

TOWN AND COUNTRY PLANNING ACT 1990

TOWN AND COUNTRY PLANNING  
GENERAL DEVELOPMENT ORDER 1988

LONDON BOROUGH OF LEWISHAM  
LAMMAS GREEN  
ARTICLE 4 DIRECTION 1992

Jon Waldman  
Acting Solicitor  
to the Council  
Town Hall  
Catford  
London  
SE6 4RU

LONDON BOROUGH OF LEWISHAM  
TOWN AND COUNTRY PLANNING ACT 1990  
TOWN AND COUNTRY PLANNING GENERAL DEVELOPMENT ORDER 1988

LONDON BOROUGH OF LEWISHAM LAMMAS GREEN  
ARTICLE 4 DIRECTION 1992

WHEREAS the Council of the London Borough of Lewisham (hereinafter called "the Council") being the Local Planning Authority for the said Borough are satisfied that it is expedient that development of the descriptions set out in the Schedule hereto should not be carried out on such parts of the land shown edged black on the plan annexed hereto and known as 13 - 39 Lammas Green (consecutive and inclusive), London SE26 (hereinafter called "the said land") in the said Borough as are set out in the corresponding column of the Schedule hereto unless permission therefor is granted on application made under the Town and Country Planning General Development Order 1988 (hereinafter called "the 1988 Order") AND WHEREAS the Council are satisfied that it is expedient to make an Order under Article 4 (1) of the 1988 Order that development as described in the Schedule hereto should not be carried out unless permission is granted for it on application under Part 3 of the Town and Country Planning Act 1990

NOW THEREFORE the Council in pursuance of the powers conferred upon th  
Article 4 of the 1988 Order as aforesaid (and in particular by Article  
thereof) HEREBY DIRECT that

- (1) the permission granted by Article 3 of the 1988 Order as aforesaid shall not apply to any development of the description set out in Column 1 of the Schedule hereto on such parts of the said land as are set out in the corresponding part of Column 2 of the Schedule, being development comprised within Part 1 Classes A1, C, D and H, and Part 2 Class C referred to in Schedule 2 of the said Order, and not being development comprised within any other part.
- (2) this Direction may be cited as " The London Borough of Lewisham Green Article 4 Direction 1992 "

PROPERTIES AFFECTED

13 to 39 (consecutive and inclusive) Lammas Green, London SE26

THE SCHEDULE

<u>Column 1</u>	<u>Column 2</u>
<u>Development affected</u>	<u>Properties affected</u>
Schedule 2 Part 1	
Class A1	
Alterations to window openings	13, 23, 24, 29, 30, 39 Lammas Green front and side elevations
	14-22, 25-28, 31-38 Lammas Green (Consecutive inclusive) front elevations
Alterations to front doors	13-39 Lammas Green (consecutive inclusive) front elevations
<del>Class B</del>	
<del>Addition or alteration to roof</del>	<del>13-39 Lammas Green (consecutive inclusive)</del>



them by  
cle 4 (1

Class C  
Any other alteration to roof

13-39 Lammas Green (consecutive inclusive)

Class D  
Erection or construction of a porch

13-39 Lammas Green (consecutive inclusive) front elevations

Class H  
Erection of a satellite dish aerial

13, 14, 16, 18, <sup>20</sup>21, <sup>22</sup>23, 24, 29, 30, 32, 34, 36, 38, 39 Lammas Green front and side elevations

15, 17, 19, ~~20~~, 25-28, 31, 33, 35, 37 Lammas Green (consecutive inclusive) front elevations

Schedule 2 Part 2

Class C  
Painting of the exterior of any building

13, 14, 16, 18, <sup>20</sup>21, <sup>22</sup>23, 24, 29, 30, 32, 34, 36, 38, 39 Lammas Green front and side elevations

15, 17, 19, ~~20~~, 25-28, 31, 33, 35, 37 Lammas Green (consecutive inclusive) front elevations

Permission will be required for all colours apart from the following to BS4800:

~~04B15~~ 08B15 10B15 12B15

The Secretary of State for the Environment hereby approves the foregoing direction subject to the modifications shown in red ink thereon.

*J A Bridges*  
Signed by authority of the Secretary of State  
12<sup>th</sup> MAY 1993  
\*An Assistant Secretary in the Department of the Environment

Dated this 20 day of June 1992

The Common Seal of the  
Mayor and Burgesses of the  
London Borough of Lewisham  
was hereunto affixed  
in the presence of:

[Signature]  
Acting Solicitor to the Council

436-23

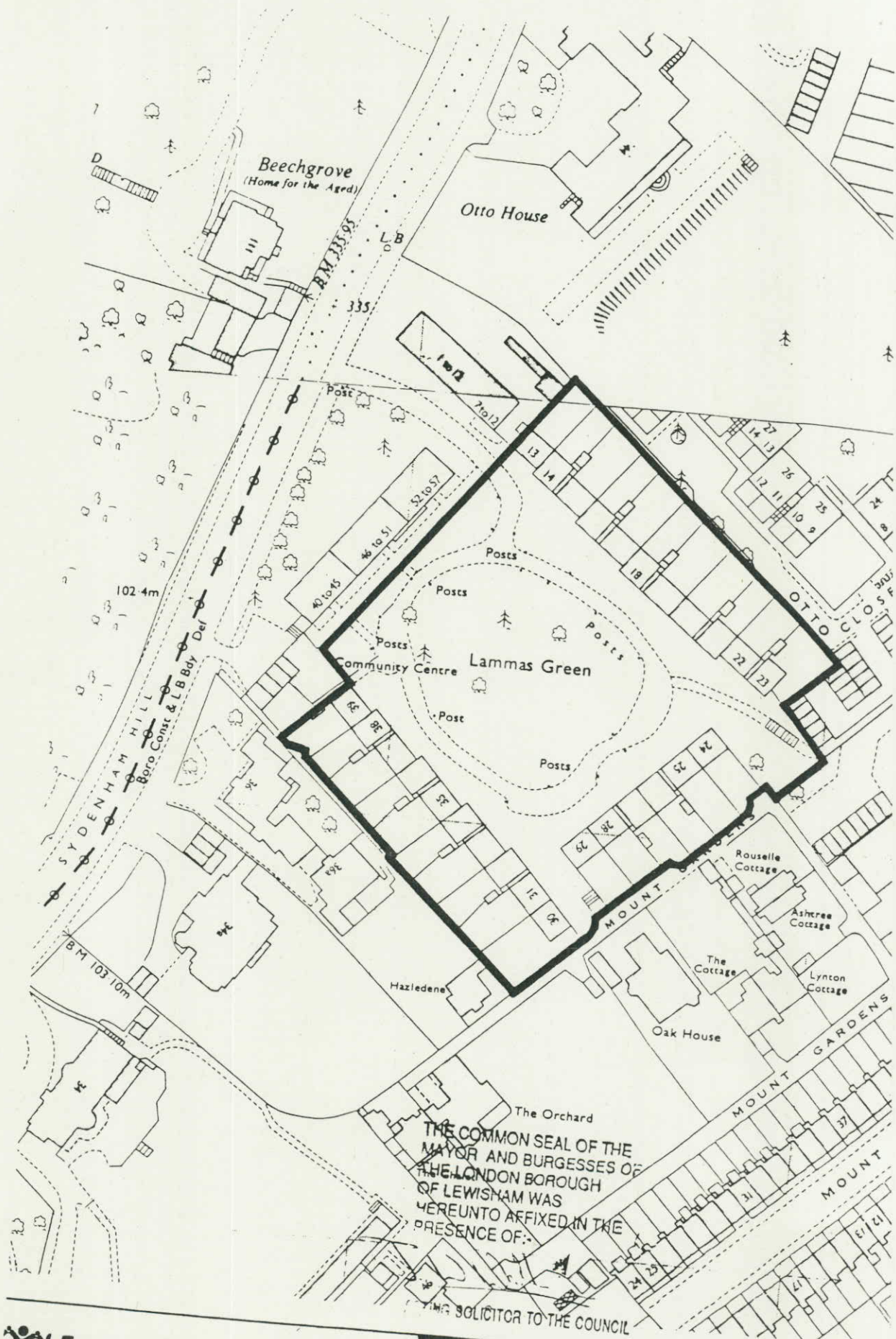

**Lewisham**

DIRECTORATE OF ENVIRONMENTAL SERVICES  
 Planning Branch  
 Town Hall Chambers,  
 Rushey Green,  
 Catford,  
 SE6 4RY.  
 081-695-6000

## ARTICLE 4 DIRECTION LAMMAS GREEN, SE26

Drawn by AP

Drawing No.