

# people, prosperity, place

Lewisham regeneration strategy 2008–2020 summary







**This leaflet gives you a taste of what's to come as Lewisham sets off on an exciting journey – the biggest transformation of the area since Victorian times.**

Lewisham is inner London's third largest borough. We're just a river's width from the City of London and with some of the best public transport anywhere in the capital.

We're a fantastically diverse area rich in green spaces, historic rivers, modern shopping and a thriving cultural scene.

And it's going to get a whole lot better over the next decade – starting right now.

Our goal is to make Lewisham the best place to live, work and learn in London – working closely with communities and businesses right across the borough.

This leaflet gives you a taste of what's to come and how you can help to make it happen.

**Sir Steve Bullock**  
**Mayor of Lewisham**

[www.lewisham.gov.uk/peopleprosperityplace](http://www.lewisham.gov.uk/peopleprosperityplace)

# A taste of things to come

We've included approximate completion dates (eg 2015) to give you a sense of how long it might take.

Don't forget to have your say too – see back cover.



**Lewisham town centre.** New homes, shops, offices and entertainment venues to transform the town centre (2015).



**New swimming pools** at Loampit Vale (2010–11) and Forest Hill (2011–12).



**New Cross NDC culture and health centre.** Includes GP surgery, library, café, gymn crèche and public square (2010).





The **extended East London Line** will cut journey times from the west of the borough to central and north London (2010–11).



**Every secondary school and all special needs facilities** in the borough to either be rebuilt or refurbished. £280 million of investment by 2018.



**10,000 new homes** being built by 2017.

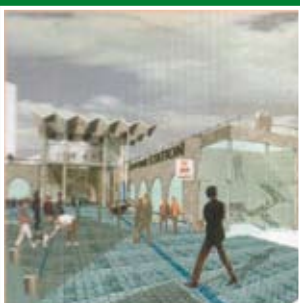

**Deptford town centre** transformed. New library, school, station, market and public square (2015).

# Already here or on their way...

New swimming pool, Deptford, 2008

Kaleidoscope Centre for Children & Young People, 2007

Downham Health & Leisure Centre, 2007

New schools opened – Forest Hill, Crofton, Childeric, Ashmead and Greenvale, 2007–08

New schools being built – Catford High, Sedgehill, for completion in 2009

Manor House Library modernised, 2008

Local assemblies – giving local people a greater say in local affairs, start 2008

Cornmill Gardens, Lewisham – award winning gardens and public square, 2007



# This is a summary of Lewisham Council's regeneration strategy for 2008–2020.

The strategy gives a broad overview of a huge range of projects, programmes and initiatives to support regeneration all over the borough.

View the full regeneration strategy at [www.lewisham.gov.uk/peopleprosperityplace](http://www.lewisham.gov.uk/peopleprosperityplace) or call 020 8314 6518 for a copy.

Keep in touch and have your say:

- Visit [www.lewisham.gov.uk/peopleprosperityplace](http://www.lewisham.gov.uk/peopleprosperityplace) to find out the latest news on all regeneration projects, including consultation events
- Read Lewisham Life to find out what's happening across the borough

## We'll know we have succeeded when...

- More people think the Council listens and responds to what they say
- Every Council/housing association tenant lives in a decent, modernised home
- More people volunteer and get involved in the local community
- New businesses come to Lewisham and people find the jobs they want
- People in Lewisham live longer and stay healthier
- Children do better at school
- We throw away a lot less and recycle a lot more
- We have safer, cleaner streets
- People can travel around quickly, easily and sustainably

In short, when people love living, working and learning in thriving, diverse communities across the whole borough.

Get the details. See our targets and detailed implementation plans at [www.lewisham.gov.uk/peopleprosperityplace](http://www.lewisham.gov.uk/peopleprosperityplace)



For translation, please provide your details below:

Për përkthim, ju lutemi shkruajini më poshtë detajet tuaja:

Pour la traduction, veuillez fournir les détails ci-dessous:

若需翻译, 请您提供下列详情:

Wixii ku saabsan turjumaad, fadlan hoos ku qor faahfaahintaada:

மொழிபெயர்ப்பிற்காக தயவுசெய்து உங்களைப் பற்றிய விபரங்களைக் கீழே அளியுங்கள்.

Tercüme edilmesi için, lütfen aşağıda detaylarınızı belirtin:

Đề dịch thuật, xin hãy cung cấp các chi tiết của bạn phía dưới:

Name:

Emri:

Nom:

姓名:

Magaca:

ጠባብ:

İsminiz:

Tên:

Address:

Adresa:

Adresse:

地址:

Cinwaanka:

முகவரி:

Adresiniz:

Địa chỉ:

- Shqip/Albanian
- Français/French
- 普通话/Mandarin
- Soomaali/Somali
- தமிழ்/Tamil
- Türkçe/Turkish
- Tiếng Việt/Vietnamese
- Other language (please state)

Return to:

Kthejeni tek:

Retourner à:

返回到:

Kusoo dir:

திருப்பி அனுப்புவதற்கான முகவரி:

Şu adrese geri gönderiniz:

Göi trã về:

Lesley Lee  
 Regeneration  
 2nd Floor  
 Laurence House  
 Catford Road  
 London  
 SE6 4RU

For other formats,  
 including BSL, Braille,  
 large print, audio  
 tape or computer  
 disc contact:

lesley.lee@  
 lewisham.gov.uk  
 020 8314 6518

Publication number: REG183  
 Communications Unit

Printed by Tradewinds

Visit [www.lewisham.gov.uk](http://www.lewisham.gov.uk)  
 for all the latest news and  
 information about your  
 Council's services, and the  
 range of job opportunities we  
 currently have on offer.