

This drawing should not be scaled. Dimensions to be verified on site. Any discrepancies should be referred to the Engineer prior to work being put in hand. This drawing is the property of Waterman Infrastructure & Environment Limited, and the drawing is issued on the condition that it not copied, reproduced, related or disclosed to any unauthorised person, either wholly or in part without the consent in writing of Waterman Infrastructure & Environment Limited. Plotford Wharf, Clink Street, London SE1 9QG. 1 020 7928 7888. 1 03333 444 501

GENERAL NOTES

- LEGEND**
- CHARCON WITHERFORD STEEL REINFORCED SLABS 600 X 750 X 65mm
 - PATTERN: OFFSET STRETCHER
 - COLD MILL EXISTING CARRIAGEWAY TO A DEPTH OF 40mm, AND INLAY ULTRACOLOUR SMA SURFACE COURSE LAID BY MACHINE TO A NOMINAL DEPTH OF 40mm, WITH 10mm COARSE AGGREGATE. MIN PSV 65. AVERAGE TEXTURE DEPTH 1.3 - 1.8mm. BUT TO BE CONFIRMED. COLOUR TO BE AGREED WITH SITE ENGINEER.
 - ULTRACOLOUR SMA SURFACE COURSE LAID BY MACHINE TO A NOMINAL DEPTH OF 40mm, WITH 10mm COARSE AGGREGATE. MIN PSV 65. AVERAGE TEXTURE DEPTH 1.3 - 1.8mm. BUT TO BE CONFIRMED.
 - REMOVE EXISTING SURFACE COURSE 40mm BY COLD MILLING TO EXPOSE EXISTING BINDER COURSE. MAKE UP LEVELS BENEATH NEW SURFACE COURSE IN AC20 DENSE BINDER, TO A DEPTH OF 75mm. SURFACE COURSE TO BE LAID ON A BBA/HAPAS APPROVED BOND COAT. COLOUR TO BE AGREED WITH SITE ENGINEER AS PER STANDARD DETAIL DRAWING: 14728-101-WIE-ZZ-XX-DR-C-951105 (3B)
 - GRANITE BLOCKS 150x300x60mm PATTERN: OFFSET STRETCHER
 - 25%-G62 DARK PINK, 25%-G64 MID GREY, 25%-G82 SILVER GREY, 25%-G84 BASALT COLOUR MIXTURE
 - MARSHALLS SCOUTMOOR YORKSTONE 600mm wide x RANDOM LENGTH x 63mm THICKNESS, JOINT STAGGER TO BE 150mm.
 - COLD MILL EXISTING CARRIAGEWAY TO A DEPTH OF 40mm.
 - SURFACE COURSE TO BE 10mm HAPAS/PSV65 MAX AAV 14) LAID TO A NOM DEPTH OF 40mm.
 - SURFACE COURSE TO BE LAID ON A BBA/HAPAS APPROVED BOND COAT
 - BUS TOP LAYBY REPAIR AS PER DETAILED DRAWING: 14728-101-WIE-ZZ-XX-DR-C-951112
 - CARRIAGEWAY SURFACE CRACK REPAIR AS PER DETAILED DRAWING: 14728-101-WIE-ZZ-XX-DR-C-951111
 - RAISED ASPHALT TABLE AS PER STANDARD DETAIL DRAWING: 14728-101-WIE-ZZ-XX-DR-C-951105 (3A)
 - PROPOSED LOCATION FOR TREES PITS
 - 100mm CLEARMAC ON 100mm TYPE2 BASE. COLOUR TO BE AGREED AS ENGINEER REQUIREMENT.
 - BUFF TACTILE PAVING
 - CHARCOAL GREY TACTILE PAVING
 - GRANITE KERB 150 X 300 (100mm FACE)
 - GRANITE KERB 150 X 300 (LAID FLUSH)
 - GRANITE KERB 150 X 300 (LAID 25mm FACE)
 - GRANITE CENTER STONE KERB 150 X 300 (6mm FACE)
 - GRANITE DROPPER KERB 150 X 150 TO BE LAID IN ACCORDANCE WITH KERB HEIGHT CHANGES)
 - PAVING CHANNEL 600mm LENGTH x 150mm WIDTH, THICKNESS & TYPE TO BE AS PER SURROUNDING PAVING MATERIAL
 - GRANITE KERB (150x150mm) LAID FLUSH
 - GRANITE TRIEF KERB (300x400mm)
 - ASPHALTIC PLUG JOINT
- STREET FURNITURE**
- EXISTING LIGHTING COLUMN
 - RELOCATED LIGHTING COLUMN
 - BELISHIA BEACON
 - BOLLARD
 - CYCLE STANDTYPE TO BE DECIDED.
 - BENCH TYPE TO BE DECIDED.
 - TREE SPECIES TO BE DECIDED.

NOTES

- ROAD HUMPS - EXISTING ROAD HUMPS AND SPEED CUSHIONS (SIDE ROADS) TO BE REMOVED WHERE NECESSARY
- HIGHWAY BOUNDARY MAY NOT BE ACCURATE. LAND REGISTRY RECORDS TO BE MADE AVAILABLE TO CONFIRM THE SCHEME EXTENTS

Rev	Date	Description	By
E12	10.10.19	SINGLE YELLOW ROAD MARKING CHANGED TO DOUBLE YELLOW LINE NORTH SIDE OF BROCKLEY ROAD, AT CLIENT'S INSTRUCTION.	UF
E11	05.09.19	CROSSOVER LENGTH OUTSIDE THE CAR VAD UPDATED.	UF
E10	18.09.19	DIMENSIONS ADDED ON TREE PLANTER PITS	UF
E09	13.09.19	FOOTWAY PAVING REMOVED FROM RIVOLI BALLROOM FORECOURT	UF
E08	05.09.19	WIDTH OF LAYBY UPDATED AS PER LBL COMMENTS	UF
E07	28.08.19	DRAWING UPDATE TO SHOW KERB TIE IN POINT	UF
E06	22.08.19	DRAINAGE CHANNEL UPDATED	UF
E05	27.06.19	BOLLARDS ARE INCLUDED IN DESIGN TO AVOID PARKING ON BRIDGE. ALSO UPDATE TO SHOW COLOURED ASPHALT SHARED TABLE	UF

Project	Amendments
CROFTON PARK CORRIDOR IMPROVEMENT	

GENERAL ARRANGEMENT

Ch. 240 TO Ch.380

LONDON BOROUGH OF LEWISHAM



Crown House 2 - 8 Gloucester Road Redhill Surrey RH1 1FH
1 01342 893600 f 03333 444 501
mail@watermangroup.com www.watermangroup.com

CONSTRUCTION

Designed By	Checked By	Waterman Ref
UF	CW	WIE14728
Drawn By	Date	Scales @ A1
UF	JAN19	1:200

Project - Originator - Volume - Level - Type - Role - Number

14728-101-WIE-P1-XX-DR-C-951100 **E12**

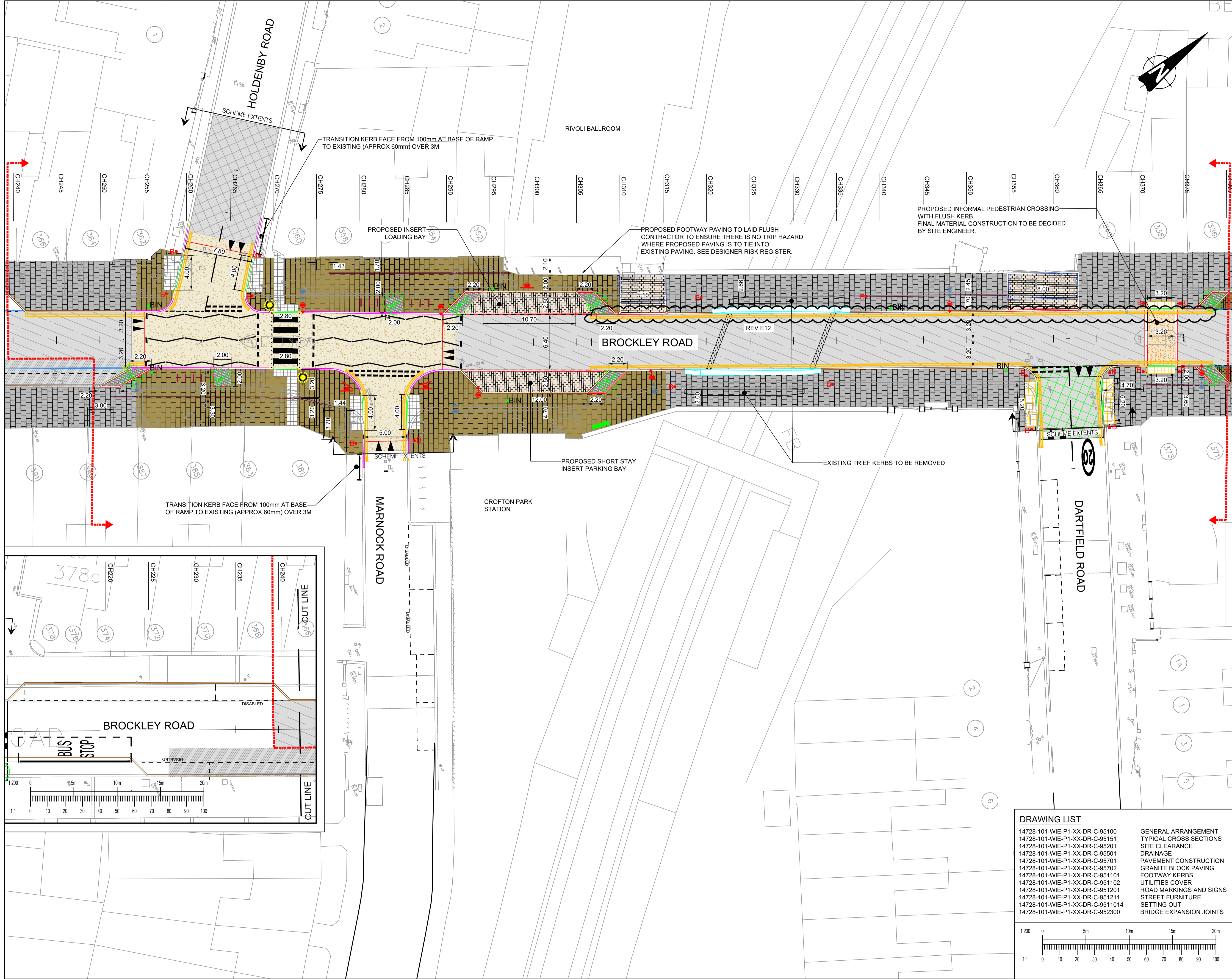

- DRAWING LIST**
- 14728-101-WIE-P1-XX-DR-C-951100 GENERAL ARRANGEMENT
 - 14728-101-WIE-P1-XX-DR-C-951101 TYPICAL CROSS SECTIONS
 - 14728-101-WIE-P1-XX-DR-C-95201 SITE CLEARANCE
 - 14728-101-WIE-P1-XX-DR-C-95501 DRAINAGE
 - 14728-101-WIE-P1-XX-DR-C-95701 PAVEMENT CONSTRUCTION
 - 14728-101-WIE-P1-XX-DR-C-95702 GRANITE BLOCK PAVING
 - 14728-101-WIE-P1-XX-DR-C-951101 FOOTWAY KERBS
 - 14728-101-WIE-P1-XX-DR-C-951102 UTILITIES COVER
 - 14728-101-WIE-P1-XX-DR-C-951201 ROAD MARKINGS AND SIGNS
 - 14728-101-WIE-P1-XX-DR-C-951211 STREET FURNITURE
 - 14728-101-WIE-P1-XX-DR-C-9511014 SETTING OUT
 - 14728-101-WIE-P1-XX-DR-C-952300 BRIDGE EXPANSION JOINTS

